

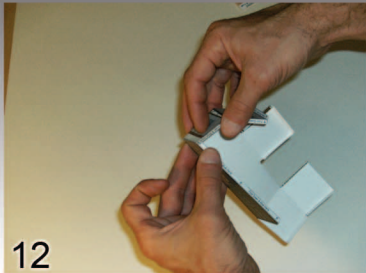

HFI - 3D CUT-OUT COLOR PAPER CLINIC MODEL FOLD-UP INSTRUCTIONS

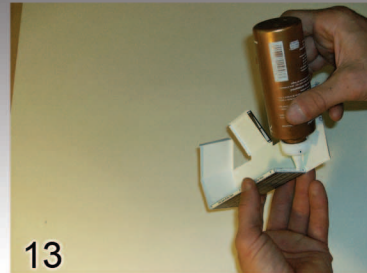

12 Hold the glued "Fold Tab" to the Folded Right Elevation, until the glue dries.



13 Repeat - on the opposite side. Glue "Fold Tab", as shown.

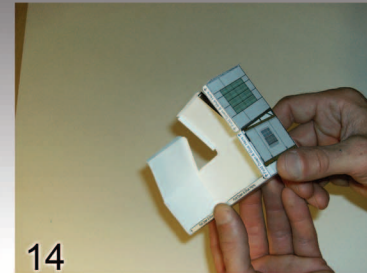

14 Hold the glued "Fold Tab" to the Folded Left Elevation, until the glue dries.

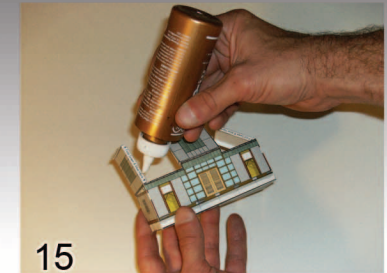

15 Place Glue on the Left Roof "Fold Tab", as shown here.

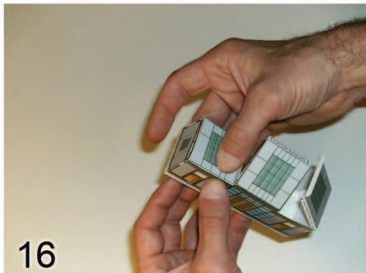

16 Hold the glued Roof "Fold Tab" to the Folded Face Elevation, until the glue dries.

-* Repeat on Opposite Side, Not Shown Here.*

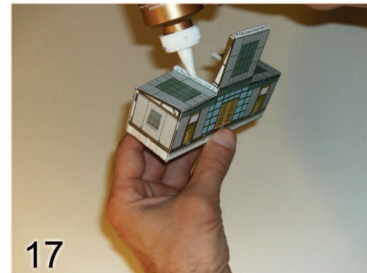

17 Place glue on the 2 remaining Roof "Fold-Up Tabs", then, Fold Down Roof Piece, and hold until the glue dries.

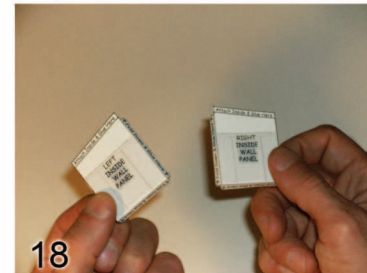

18 Next, Get the Left & Right Wall Panels, and Score & Fold along Profile Edge, as shown here, then glue edges, as indicated.

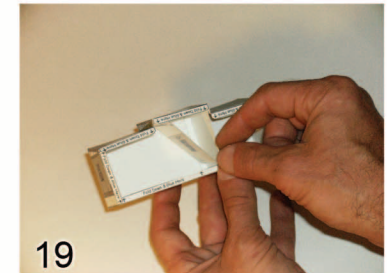

19 Place glued Wall Inside Clinic, Push Walls into upright position. Front Fold should press tight against Front Wall, and top side against the side Top Panel.

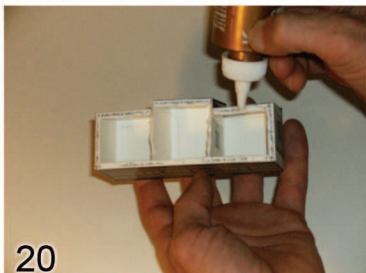

20 Glue the "Fold Tabs" on the Back of the Clinic

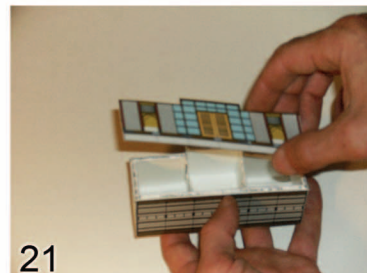

21 Carefully, Place the Rear Elevation Panel on the Back of the Clinic, Then, Hold until dry.



22 Roll Up the Brown Squares, and Glue along the edge, to make Pilings for the Clinic.

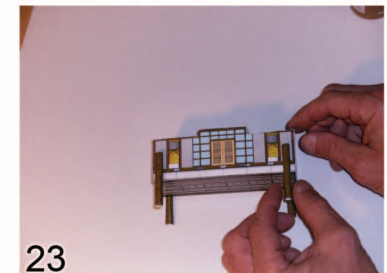

23 Last, place a mark 1" from the end of the Piling, align the mark to bottom edge of the Elevation, and Glue.